

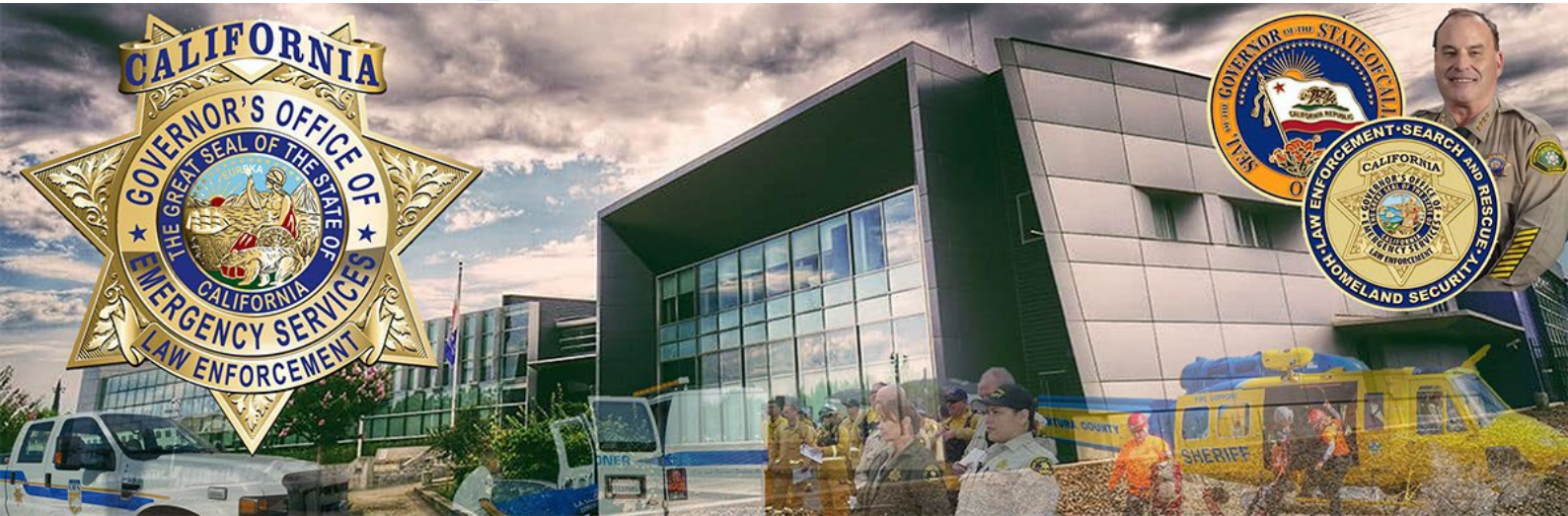

# Law Enforcement Mutual Aid Assistance Fund Mosquito Fire-El Dorado

Gavin Newsom, Governor



## LEMA APP

All reimbursement requests can be submitted on-line:

### ONLINE - LEMA APP

## LEMA INCIDENT PERIOD

- September 7, 2022- September 20, 2022
- Responding Agency – El Dorado County

## Important Application Information

- LEMA Workbook
- Invoice w/Invoice #
- ICS-214's for personnel deployed
- Timecard Sheets for personnel deployed
- Payroll Breakdowns for personnel deployed

## LEMA Fund Reimbursement Process

1. Cal OES LEMA Team will contact the Requesting Agency to obtain:
  - 214's
  - Post Event Summary Agreement between the Requesting Agency and the Providing Agency (MOU)
2. LEMA Team will contact Providing Agencies to request:
  - Timecards
  - Payroll Breakdowns
3. LEMA Team will process reimbursement request from the Providing Agencies.
4. All correspondence will take place through the LEMA Fund online portal  
Reimbursement request packets will include two invoices as follows:
  - A LEMA Fund Invoice
 Providing Agencies will be able to access their LEMA Fund online account to track the progress of their reimbursement.
  - An Invoice for the Requesting Agency with other eligible expenses outside of the LEMA Fund
5. Cal OES Recovery will work with the Requesting Agency to process all eligible expenses outside of the LEMA Fund.

## Eligible Expenses

- Responding officer Overtime
- Backfill for responding officer
- Lodging
- Per Diem
- Mileage- to & from incident.
- Fuel
- Extraordinary Equipment
- ❖ Overtime, backfill, and fuel will be reimbursed at the actual costs.
- ❖ Lodging, per diem, and mileage will be reimbursed at the State Rate.

## Eligible Agencies

Sworn members of:

- City Police Departments
- Sheriff's Offices
- Probation
- District Attorney's

FOR MORE INFORMATION CONTACT US:

LemaFund@caloes.ca.gov

Jodi Lopez  
Staff Services Manager II  
Law Enforcement Branch  
(916) 845-8307

Pooja Randhawa  
Staff Services Manager I  
Law Enforcement Branch  
(916) 845-8743

Taryn Renowden  
AGPA LEMA Program  
Law Enforcement Branch  
(916) 845-8705

Nancy Talley  
AGPA LEMA Program  
Law Enforcement Branch  
(916) 845-8706